



Vacuum Cleaner

with water-based filtration

User Manual



CE

StillVac



Dear Customer,

Thank you for choosing our product. We hope that Aura vacuum cleaner, which have been manufactured in modern facilities and under high-quality standards, will provide the best solution for your needs. Please read the entire user manual thoroughly and keep it for future reference.

StillVac





Safety Precautions

Please read before using your appliance!

- This device is designed only for domestic use.
- Before plugging your device in, check that the mains electricity is suitable for the voltage specified on the technical information label.
- No grounding is required as your device is fully insulated. You can safely use it in a groundless socket.
- Before operating the device, be sure to check the device or power cord for damage. If there is any damage, do not operate your device and contact your nearest Aura Authorized Service.
- Do not leave the device plugged in when it is not in use. Turn off your device before unplugging. When removing the plug from the socket, do not pull the plug by the cable.
- Do not pull or carry the device by its power cable. Do not allow the cable to be caught by a door. Keep power cable away from sharp edges and hot surfaces.
- Power cord should be checked regularly for damages. The device should not be used with a damaged cable. If the power cord is damaged, it must be replaced by an equivalent cord or cord set available from its manufacturer or service agent. This operation must be done by an authorized service.
- Do not vacuum burning, smoking or smoldering things like cigarettes, matches or hot ashes. Never use your device to clean flammable liquids such as gasoline, alcohol, fuels, or where these substances may be found.
- Never use your device to clean the oil, soot, chimney dust, ceramic powder, lime dust, gypsum dust, or to cleaning fireplaces.
- Never use your device to clean volatile and toxic substances or near these substances.
- Always unplug your device before starting maintenance and cleaning.
- The appliance can be used by children aged from 8 years and above and persons with reduced physical, sensory or mental capabilities or lack of experience and knowledge if they have been given supervision or instruction concerning use of the appliance in a safe way and understand the hazards involved. Children shall not play with the appliance. Cleaning and user maintenance shall not be made by children without supervision.
- Do not allow your device to be used by children as a toy or to be operated by children without supervision. Children should be supervised to ensure they do not play with the device.
- Do not try to repair the device after malfunctioning or any other situation you may suspect. Please contact the Authorized Service.

Technical Specifications

Model	114IW	Water Suction Rate	1 - 1,5 L/sec.
Motor Power (max)	1000 Watt	Dirty Water Tank Capacity	6 L
Vacuum	1950 mmSS	Weight	8,4 kg
Voltage / Frequency	220 - 240 V AC, 50/60 Hz	IP Code	IPX4
Air Flow	200m ³ /h	Protection Class	II

Accessories



1- Daily cleaning nozzle, 2- Elliptical brush, 3- Crevice tool, 4- Suction hose, 5- Telescopic tube, 6- Air outlet filter, 7- Sponge filter, 8- Filter cover, 9- Filter slot, 10- Blowing adaptor, 11- Suction group

Usage

Sweeping

Our bagged vacuum cleaners are equipped with multipurpose accessories and engineered with economic design for dry sweeping and wet spill vacuuming.



Open head unit by releasing both securing clips.



Lift head unit from dirt collection tank.



Place the sponge filter in the direction of the arrow.



Place the filter slot in the direction of the arrow.



Tighten the filter securing lock clockwise.



Add clean water up to the level indicated.



Attach suction hose to the inlet connector.



Insert handle into end of the telescopic tube



Attach floor cleaning nozzle to the telescopic tube and lock it in place.



Press on green (on/off) button for power. If machine is on, the led light will be illuminated.

NOW, YOUR DEVICE IS READY FOR SWEEPING

Blowing



In order to use the blowing feature, remove the cover and sponge filter on the rear air outlet duct of your device and attach the blowing apparatus (Accessories 10). Turn on the device by inserting the hose end into the blowing apparatus. The blowing feature is ready to use.

Wet spill vacuuming

In the event of a wet spill in your home, your device can be used to remove liquids from your floor.

WARNING

Do not use your device to vacuum any hazardous liquids like flammable liquids, corrosives, acids, oil based liquids, etc...

Use the following steps convert your device from sweeping mode to wet vacuuming mode.



Lift the head unit from the dirt collection tank.



Place the sponge filter in the direction of the arrow.



Place the filter slot in the direction of the arrow.



Tighten the filter securing lock clockwise.



Make sure that the tank is empty.



Attach the suction hose to the inlet connector.



Press power on green (on/off) button. If machine is on, the led light will be illuminated.

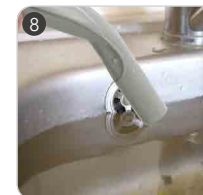

You can vacuum the accumulated water with the end of the suction hose.

WARNING

During vacuuming, if the water level is exceed in the tank, the sound of the device will be increased. In that case, unplug your device and discharge the water from the tank.

Cleaning and maintenance

- Turn off the on/off switch and unplug the device. Remove all attachment and suction-hose from the device.
- Empty the dirty water reservoir, wipe with a cloth to remove dirt, rinse thoroughly with warm water and allow to dry completely before storage.
- Remove sponge filter, rinse and allow to dry completely.
- Rinse and clean all parts and accessories thoroughly and allow to dry completely.
- To clean the suction-hose, flush clean by running hot tap water through it and allow to dry completely before using again or storage.

WARNING

Maintenance must be performed by an authorized service technician.



ihlas 
Ev Aletleri

BOSB Mermerciler San. Sit. 7. Cad. No:14 / 34524 Beylikdüzü / İSTANBUL
Tel: +90 212 875 35 62 / Faks:+90 212 875 36 64
www.iea.com.tr - info@iea.com.tr

CE

