



# Vacuum Cleaner

Carpet washing system

## U s e r M a n u a l



CE

QVac Model 114H

LiVac Model 114R

## *Dear Customer,*

Thank you for choosing our product. We hope that Aura Vacuum Cleaner and Carpet Washing System, which have been manufactured in modern facilities and under high-quality standards, will provide the best solution for your needs. Please read the entire user manual thoroughly and keep it for future reference.





# Contents

---

Safety precautions	4
Technical specifications	5
Accessories	6
Usage	7
- Sweeping	7
- Wet spill vacuuming	8
- Carpet washing with shampoo	9-10
Point to considerations	10
Cleaning and maintenance	11

# Safety Precautions

## Please read before using your appliance!

- This device is designed only for domestic use.
- Before plugging your device in, check that the mains electricity is suitable for the voltage specified on the technical information label.
- No grounding is required as your device is fully insulated. You can safely use it in a groundless socket.
- Before operating the device, be sure to check the device or power cord for damage. If there is any damage, do not operate your device and contact your nearest Authorized Service.
- Do not leave the device plugged in when it is not in use. Turn off your device before unplugging. When removing the plug from the socket, do not pull the plug by the cable.
- Your device is equipped with an automatic cable winding mechanism. Do not force the cable to push in, do not use it unnecessarily and do not let your children use it as a toy.
- Do not pull or carry the device by its power cable. Do not allow the cable to be caught by a door. Keep power cable away from sharp edges and hot surfaces.
- Power cord should be checked regularly for damages. The device should not be used with a damaged cable. If the power cord is damaged, it must be replaced by an equivalent cord or cord set available from its manufacturer or service agent. This operation must be done by an Authorized Service.
- Do not vacuum burning, smoking or smoldering things like cigarettes, matches or hot ashes. Never use your device to clean flammable liquids such as gasoline, alcohol, fuels, or where these substances may be found.
- Never use your device to clean the oil, soot, chimney dust, ceramic powder, lime dust, gypsum dust, or to cleaning fireplaces.
- Never use your device to clean volatile and toxic substances or near these substances.
- Always unplug your device before starting maintenance and cleaning.
- The appliance can be used by children aged from 8 years and above and persons with reduced physical, sensory or mental capabilities or lack of experience and knowledge if they have been given supervision or instruction concerning use of the appliance in a safe way and understand the hazards involved. Children shall not play with the appliance. Cleaning and user maintenance shall not be made by children without supervision.
- Do not allow your device to be used by children as a toy or to be operated by children without supervision. Children should be supervised to ensure they do not play with the device.
- Do not try to repair the device after malfunctioning or any other situation you may suspect. Please contact the Authorized Service.

# Technical Specifications

Model	114H / QVAC	114R / LIVAC
Wet/Dry Sweeping	✓	✓
Washing Function	✓	✓
Motor Power (max)	1000 Watt	1000 Watt
Vacuum	1950 mmSS	1950 mmSS
Voltage / Frequency	220 - 240 V AC, 50/60 Hz	220 - 240 V AC, 50/60 Hz
Air Flow	200m <sup>3</sup> /h	200m <sup>3</sup> /h
Water Suction Rate	1 - 1,5 L/sec.	1 - 1,5 L/sec.
Fresh Water Tank Capacity	7 L	3,5 L
Dirty Water Tank Capacity	8,5 L	6 L
Weight	12,7 kg	10,8 kg
IP Code	IPX4	IPX4
Protection Class	II	II



# Accessories

## Sweeping & Washing



- 1- Floor cleaning nozzle, 2- Elliptical brush, 3- Crevice tool, 4- Suction hose, 5- Telescopic tube, 6- Cartridge filter, 7- Dust bag, 8- Filter cover, 9- Big washing nozzle, 10- Hard floor rubber, 11- Mini washing nozzle, 12- Washing set spray pipe, 13- Sponge filter, 14- Clean water tank, 15- Pipe clamp, 16- Spray trigger, 17- Dirty water reservoir (Only QVac), 18- Suction pipe, 19- Shampoo, 20- Blowing adaptor.

# Usage

## Sweeping

- Our bagged vacuum cleaners are equipped with multipurpose accessories and engineered with economic design for dry sweeping and wet spill vacuuming.



1- Open head unit by releasing both securing clips.



2- Lift head unit from dirt collection tank.



3- Attach dust bag in place.



4- Insert cartridge filter as shown by inserting and turning the lock clockwise.



5- Replace head unit on dirt collection tank and lock the clips.



6- Attach suction hose to inlet connector.



7- Insert the handle into end of telescopic tube.



8- Attach floor cleaning nozzle to telescopic tube and lock it in place.



9- Pull power cable and insert its plug into the main power supply.



10- Press power on green button. If machine is on, the led light will be illuminated.

**NOW, YOUR DEVICE IS READY FOR SWEEPING**

## IMPORTANT

- The pump switch must **NOT** be used in any vacuuming mode. Use of the pump without water will lead to **PUMP FAILURE**. Only switch the pump on when using your device for carpet washing purpose.
- It is recommended that all filters be checked and cleaned after each use.

## Wet spill vacuuming

In the event of a wet spill in your home, your device can be used to remove liquids from your floor.

### WARNING

Do not use your device to vacuum any hazardous liquids like flammable liquids, corrosives, acids, oil based liquids, etc...

Use the following steps convert your device from sweeping mode to wet vacuuming mode.



Lift the head unit from the dirt collection tank.



Remove the dust bag from the dirt collection tank.



Remove the cartridge filter by turning the lock anticlockwise and pulling outwards.



Instead of cartridge filter, fasten sponge filter in-place by inserting.



Tighten the filter securing lock clockwise.



Replace head unit on dirt collection tank and lock the clips.

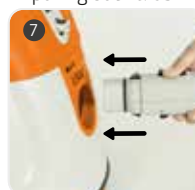

Attach suction hose to inlet connector.



Insert handle into end of telescopic tube



Attach big/mini washing nozzle to telescopic tube and lock it in place.



If needed, attach the rubber to the big/mini washing nozzle by sliding tool onto the front of the head.



Pull power cable and insert its plug into the main power supply.



Press power on button. If machine is on, the led light will be illuminated.

### WARNING

During vacuuming, if the water level is exceeded in the tank, the sound of the device will be increased. In that case, unplug your device and discharge the water from the tank.

**NOW, YOUR DEVICE IS READY TO VACUUM WET SPILLS.**



## Carpet washing with shampoo

AURA is an exceptional carpet cleaner. Clean your carpet or furniture to keep them free from harmful allergens, in addition to remove stubborn stains for a healthy home.

### IMPORTANT

Be sure of that; surfaces to be washed must thoroughly swept first.

Use the following steps to set up your device for carpet or furniture washing.



Remove the dust bag from the dirt collection tank.



Instead of cartridge filter, fasten sponge filter in-place by inserting.



Replace head unit on dirt collection tank.



Secure head unit by using the securing clips.



Attach suction hose to inlet connector.



Insert handle into end of telescopic tube.



Attach big/mini washing nozzle to telescopic tube and lock it in place.



Attach clean water tank to the rear of the dirt collection tank.



Fill the tank with tap water. **DO NOT FILL HOT WATER.**



Pour two caps of shampoo in to the clean water tank.



Insert the suction pipe to the inlet port of head unit.



Attach spray trigger to the handle.



Insert long end of washing set's spray pipe to the checkvalve inlet.



Secure the spray pipe to the external surface of suction hose using three of the securing clamps.



Attach washing set's spray pipe extension to the free end of washing set tube and lock it by turning.

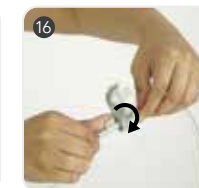



Secure washing set's spray pipe to external surface of telescopic tube using securing clamps.



Attach the free end of washing set's pipe extension to the carpet washing nozzle.

- To attach pipe extension, insert and turn the pipe clockwise 90 degrees.
- To release turn anticlockwise 90 degrees and remove



First press green button for power. If machine is on, the led light on the switch will be illuminated. Then press on red button for pump. If pump is on, the led light on the switch will be illuminated.

**NOW, YOUR DEVICE IS READY FOR CARPET WASHING.**

## IMPORTANT

**DO NOT** operate the pump when there is no water in the clean water tank. **DO NOT** use hot or warm water.

### Blowing



In order to use the blowing feature, remove the cover and sponge filter on the rear air outlet duct of your device and attach the blowing apparatus (Accessories 20). Turn on the device by inserting the hose end into the blowing apparatus. The blowing feature is ready to use.

## Points to consider

- Use Aura shampoo in your product. You can provide Aura shampoo from authorized services.
- Another shampoo or powder detergent to be used in your product may create a lot of foam and this may leak into the motor and cause a malfunction.
- If the water in the tank runs out while the pump is running, turn off the water pump. Using the pump without water will lead to PUMP FAILURE.
- Repeat the cleaning process a few times for heavily soiled carpets or furnitures.
- Ventilate newly washed surfaces and let them dry approximately two hours. Do not use them during this period.

# Cleaning and maintenance

Your AURA will give you years of outstanding service. You have a part to play in extending the life of your device. To ensure that your AURA continues to provide you with excellent service and your family with a healthier home to live in, follow these simple cleaning and maintenance instructions.

## After sweeping

- Turn off the on/off switch and unplug the device.
- Remove all attachment and vacuum-hose from the device.
- Open the locking latches and separate the head unit from tank group.
- Take the dust bag out of the sliding slot on the tank group and replace it with a new one when the dust bag is full.

**NOTE:** To clean cartridge filter, use a soft brush for visible dirt/dust. DO NOT use water or any liquid to clean cartridge filter!

## After carpet washing and wet vacuuming

- Turn off the on/off switch and unplug the device.
- Remove all attachment and vacuum-hose from the device.
- Empty the dirty water reservoir, wipe with a cloth to remove dirt, rinse thoroughly with water and allow to dry completely before storage.
- Remove sponge filter, rinse and allow to dry completely.
- Rinse and clean all parts and accessories (except cartridge filter that cannot be wet) thoroughly and allow to dry completely.
- To clean the vacuum-hose, flush clean by running tap water through it and allow to dry completely before using again or storage.

## WARNING

Always unplug the device from the mains power. Before use start with cleaning and maintenance.

Maintenance must be performed by an authorized service technician.

# ihlas Ev Aletleri

BOSB Mermerciler San. Sit. 7. Cad. No:14 / 34524 Beylikdüzü / İSTANBUL  
Tel: +90 212 875 35 62 / Faks:+90 212 875 36 64  
[www.iea.com.tr](http://www.iea.com.tr) - [info@iea.com.tr](mailto:info@iea.com.tr)

CE

